

IRRIGATION TO BE INSTALLED AT TIME OF PLANTING. COVERAGE FOR SHRUBS, TREES AND LAWN FINAL LAYOUT AND TYPE TO BE DETERMINED BY CERTIFIED IRRIGATION DESIGNER

ROOT BARRIER TO BE INSTALLED FOR ANY TREES PLANTED WITHIN 2M OF SIDEWALK OR ROADWAYS

NO BOULEVARD TREE TO BE PLANTED ON WEST SIDE OF DRIVEWAY. TOO MANY UNDERGROUND SERVICES ENTER THE PROPERTY ON THIS SIDE. THERE IS NO SPACE TO ALLOW FOR PROPER GROWTH OF A TREE AND ITS ROOT SYSTEM.

THE CITY MAY PLANT A CITY TREE WEST OF THE PROPERTY, AS SPACE ALLOWS.

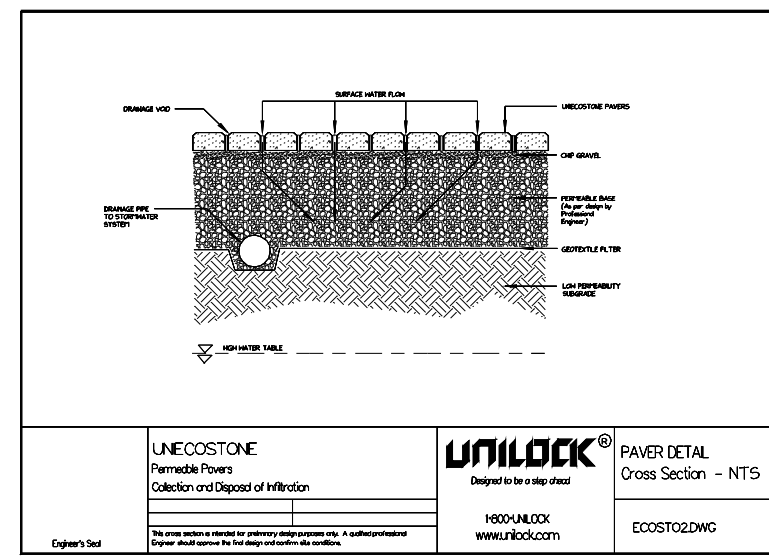

EXAMPLE OF PERMEABLE PAVERS TO BE USED FOR DRIVEWAY ENTRANCE, PARKING SPACES AND CROSSWALKS. ACTUAL BRAND AND STYLE OF PAVES TO BE DETERMINED AT TIME OF CONSTRUCTION.



BOXWOOD PLANTED 0.45CM OC
HYDRANGEA PLANTED 100CM OC

Qty	Botanical Name	Common Name	Size/Condition
Trees			
2	CERCIS CANADENSIS 'FOREST PANSY'	FOREST PANSY REDBUD	5CM CAL
1	STEWARTIA PSEUDOCAMELLIA	STEWARTIA	5 CM CAL
Shrubs			
76	BUXUS SEMPERVIRENS 'SUFFRUTICOSA'	BOXWOOD	2 GAL
48	HYDRANGEA ARBORESCENS 'INVINCIBELLE WEE WHITE'	INVINCIBLE WEE WHITE SMOOTH HYDRANGEA	3 GAL

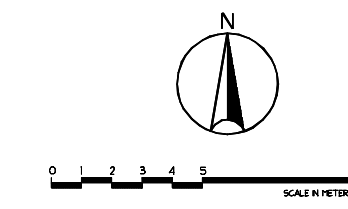
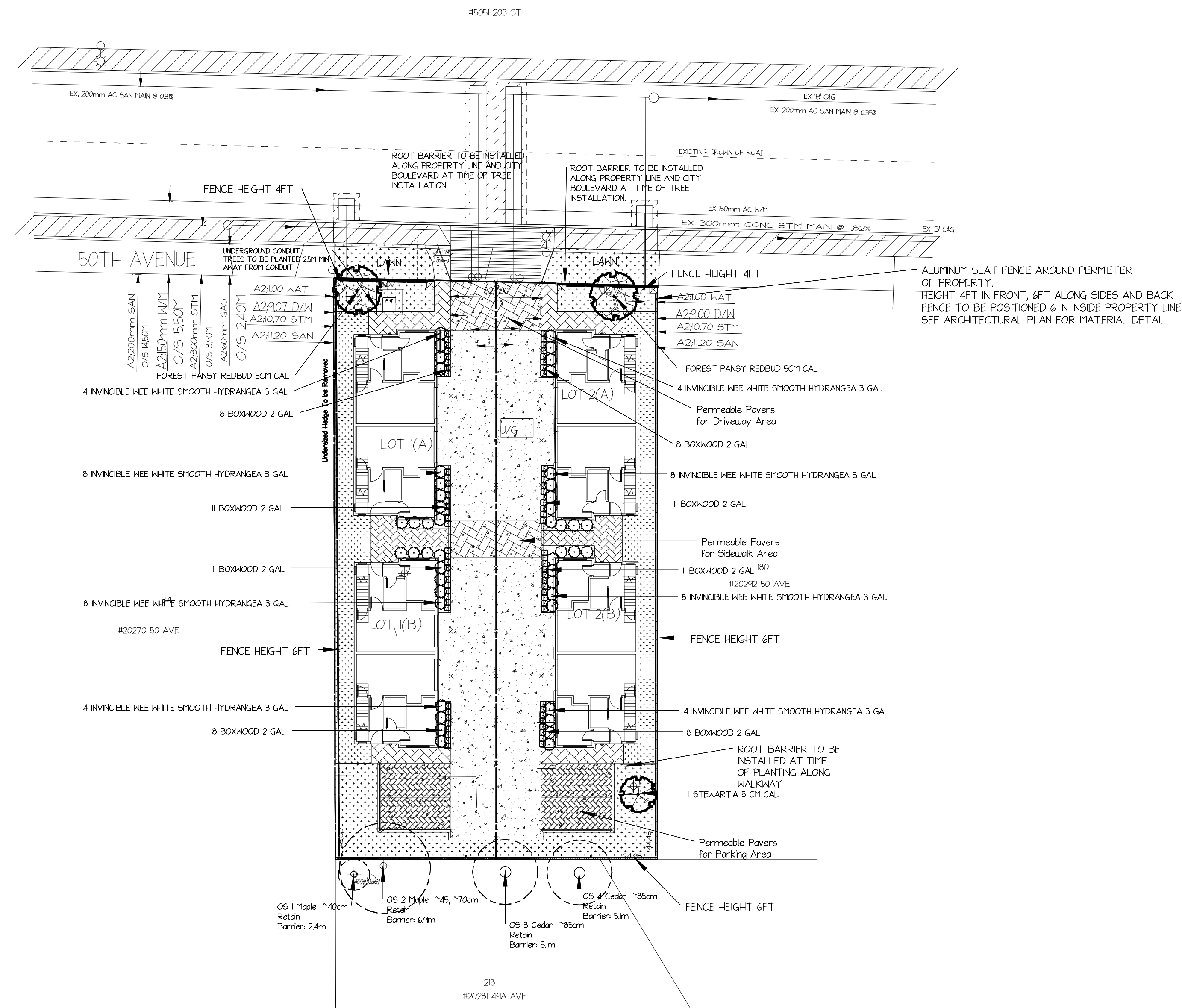

Notes
1. LANDSCAPE CONTRACTOR SHALL HAVE THE MINIMUM QUALIFICATIONS OF THREE YEARS LANDSCAPE CONSTRUCTION EXPERIENCE AND CERTIFIED AS A LANDSCAPE TECHNICIAN OR BE A JOURNEYMAN HORTICULTURIST, OR HAVE COMPLETED A TWO YEAR DIPLOMA IN HORTICULTURE WITH ONE YEAR EXPERIENCE AS A LANDSCAPE CONTRACTOR.

2. ANY ADDED SOIL OR SOIL AMENDMENTS SHALL MEET OR EXCEED CANADIAN LANDSCAPE STANDARD.

3. PLANT MATERIALS SHALL MEET OR EXCEED THE CANADIAN LANDSCAPE STANDARD, LATEST EDITION, FOR NURSERY STOCK SIZE AND QUALITY. PLANT MATERIALS LISTED IN THE ACCOMPANYING PLANT LIST HAVE BEEN SPECIFIED ACCORDING TO THE CANADIAN NURSERY AND LANDSCAPE STANDARD, CANADIAN STANDARDS FOR NURSERY STOCK, THE BCLNA STANDARD FOR NURSERY STOCK AND THE BCLNA STANDARD FOR CONTAINER GROWN PLANTS. NURSERY SHALL BE CERTIFIED FREE OF P. RAMORUM (SODS).

4. PLANT MATERIAL SHALL BE INSPECTED AT THE SOURCE NURSERY FOR APPROVAL BY THE LANDSCAPE CONSULTANT AS WELL AS AT THE TIME OF DELIVERY TO SITE.

5. PLANT SUBSTITUTIONS ARE PERMITTED ONLY WITH APPROVAL BY THE LANDSCAPE CONSULTANT.

6. LANDSCAPE CONTRACTOR SHALL TAKE MEASURES TO PREVENT UNNECESSARY SOIL COMPACTION DURING LANDSCAPE WORK.

7. PLANTING DEPTHS IN APPROVED SOIL MEDIA SHALL MEET OR EXCEED STANDARDS AS DESCRIBED IN THE LATEST EDITION OF THE CANADIAN LANDSCAPE STANDARD SOIL DEPTHS AS FOLLOWS:
PERENNIALS AND ANNUALS - 30CM
SMALL SHRUBS - 45CM
LARGE SHRUBS - 60CM
TREES - MINIMUM 90CM FOR A 10M SQ AREA
LAWN - 15CM

8. ALL GRADING AND DRAINAGE SHALL BE DONE IN ACCORDANCE WITH BEST MANAGEMENT PRACTICES AND THE LATEST EDITION OF THE CANADIAN LANDSCAPE STANDARD

9. PLANT MATERIALS SHALL BE GUARANTEED TO THE CLIENT FOR A PERIOD OF SIX MONTHS AFTER SUBSTANTIAL COMPLETION AGAINST DEATH DUE TO UNHEALTHY SUPPLY OR INSTALLATION CONDITIONS AND WRONG SPECIES OR VARIETY.

10. ALL GARDEN BEDS TO HAVE A 5CM LAYER OF MULCH APPLIED ONCE PLANTING COMPLETE. ENSURE MULCH DOES NOT TOUCH TRUNKS OR STEMS OF PLANTS

LEGAL DESCRIPTION
LOT #2 DL 305, GP 2 NEW WESTMINSTER DISTRICT PLAN 34549

BENCH MARK
ELEVATIONS ARE GEODETIC REFERRED TO MONUMENT 744525
MONUMENT ELEVATION: 1.591 LOCATED AT: THE INTERSECTION OF 50 AVENUE & 202A STREET
VERTICAL DATUM: V028GVRD208



ANNE KULLA ISA 6263-A DIPL. LANDSCAPE DESIGN
ISA CERTIFIED ARBORIST
PHONE: 604-725-3025
EMAIL: ANNE@HUCKLEBERRYLANDSCAPE.CA
ADDRESS: 305 NICHOLAS CR., LANGLEY, BC

Anne Kulla

REV#	DATE	DRN	CHD
07	May 11/26	AK	
06	APR 14/26	AK	
06	JAN 18/26	AK	
05	NOV 02/25	AK	
04	SEP 24/25	AK	
03	Aug 02/25	AK	
02	JULY 14/25	AK	

NAME	DATE
DESIGNED	AK 04/07/25
DRAWN	AK 04/07/25
REVIEWED	
APPROVED	
PROJECT No.	25-051
SCALE	1:50

SHEET NO.	DWG NO.	REV NO.
06 OF 09		
	601	
		00

LANDSCAPE PLANTING PLAN
DUPLX DEVELOPMENT
#20280 50 AVE, LANGLEY, BC
1509734 BC LTD. & 1509640 BC LTD.
604-849-4299
DENCITY@CONSULTANT.COM
20280 50AVE, LANGLEY BC, V3A 3T1