

NOTICE OF INTENDED PROPERTY DISPOSITION

Pursuant to Section 26 of the Community Charter, the City of Langley gives notice on its intention to lease a small space (104 square feet, called License Area A) at Timms Community Centre, 20399 Douglas Crescent, to Stacy's Cookies. This area is highlighted in pink on the map below.

Stacy's Cookies will operate a café in this space for an initial term of two years, with a monthly lease rate of \$300. After the first two years, there is an option to renew the lease for another two years.

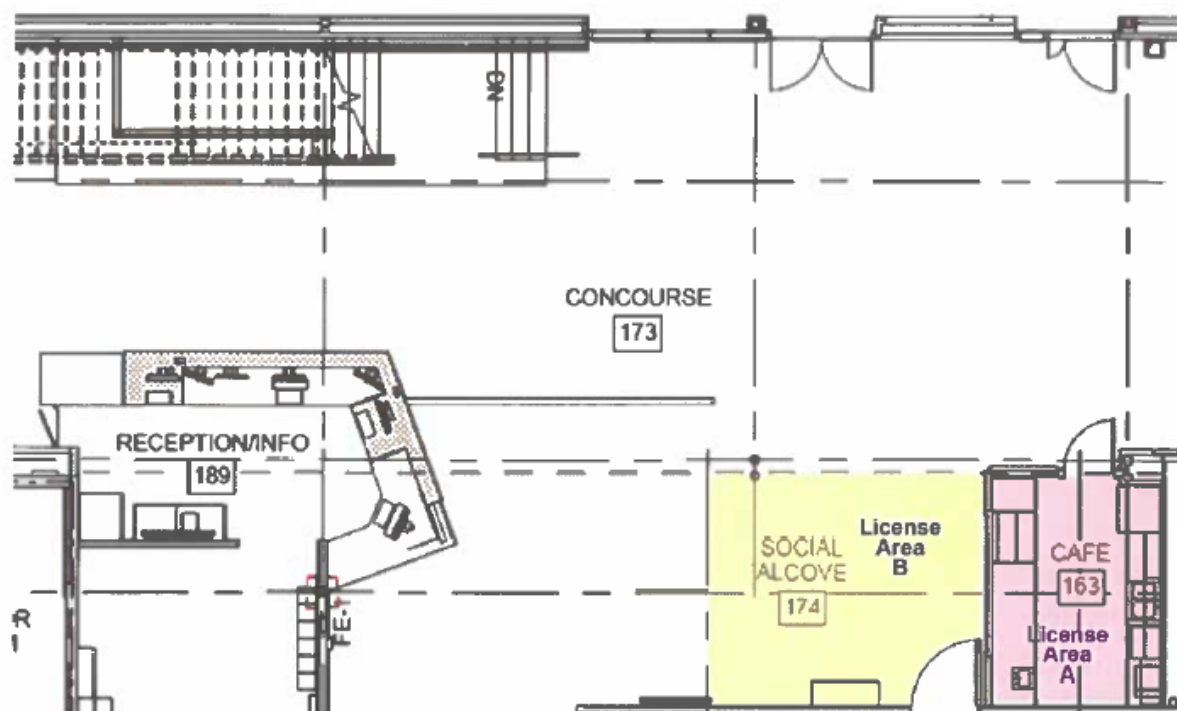

Coffee Shop (Café) Location in relation to Lobby on Main Floor License Area A and B