

SEAL:

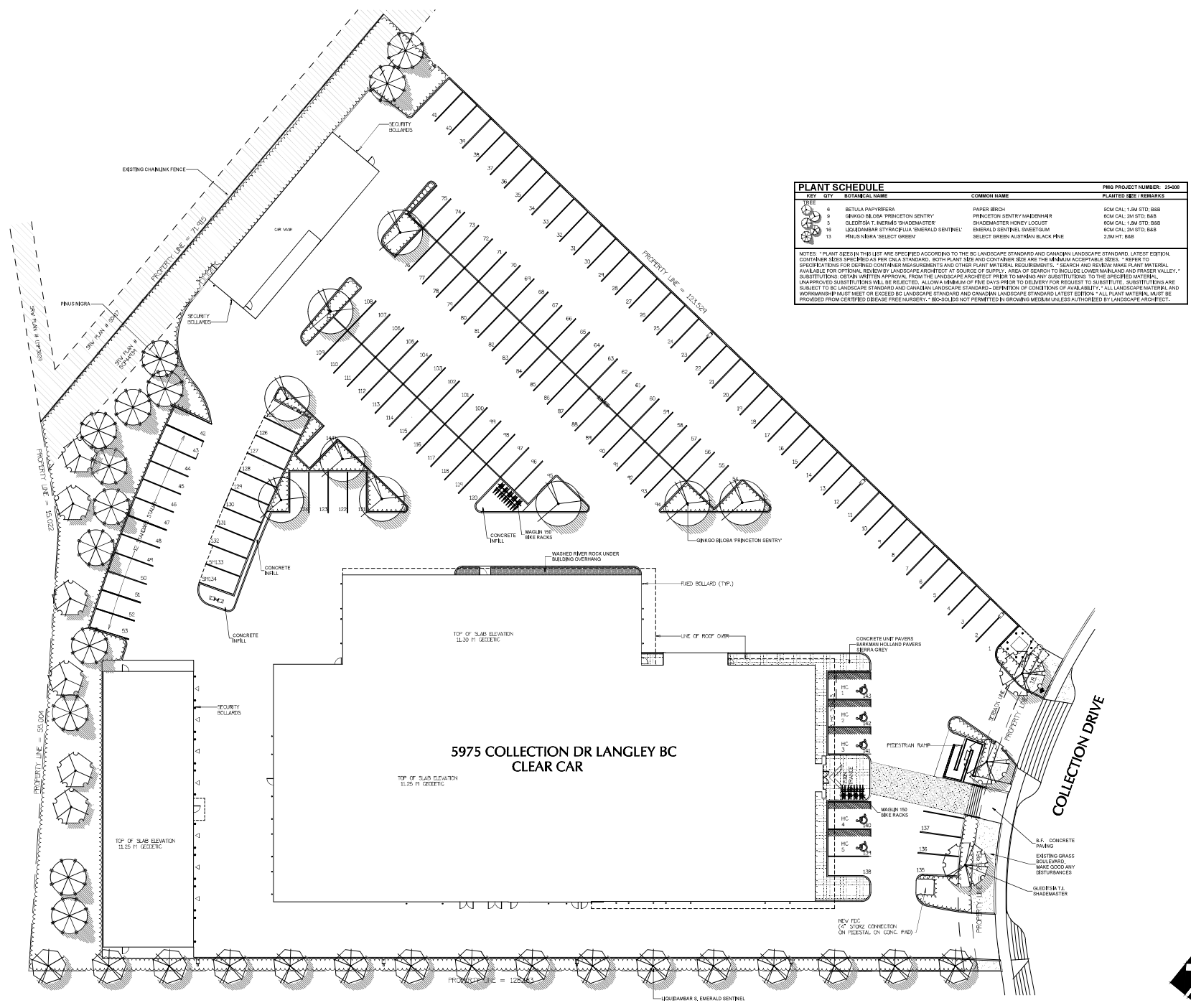

PLANT SCHEDULE				PMG PROJECT NUMBER: 25008
KEY	QTY	BOTANICAL NAME	COMMON NAME	PLANTED SEE / REMARKS
6		BETULA Papyrifera	PAPER BIRCH	80M CAL 1.8M STD. B&B
9		QUERCUS BL. OBA PRINCETON SENTRY	PRINCETON SENTRY MADROENHÄHR	80M CAL 2M STD. B&B
3		OLEIFER T. L. SHADENMASTER	SHADENMASTER HONEY LOCUST	80M CAL 1.8M STD. B&B
16		LIQUIDAMBAR STYRACIFLUA 'EMERALD SENTINEL'	EMERALD SENTINEL SWEETGUM	80M CAL 2M STD. B&B
13		FINUS NIGRA 'SELECT GREEN'	SELECT GREEN AUSTRALIAN BLACK PINE	2.2M HT. B&B

NOTES: * PLANT SEES IN THIS LIST ARE SPECIFIED ACCORDING TO THE BC LANDSCAPE STANDARD AND CANADIAN LANDSCAPE STANDARD, LATEST EDITION. CONTAINER SEES SPECIFIED AS PER LOCAL STANDARD, BOTH PLANT SEE AND CONTAINER SIZE ARE THE MINIMUM ACCEPTABLE SIZES. * REFER TO SPECIFICATIONS FOR DEFINED CONTAINER MEASUREMENTS AND OTHER PLANT MATERIAL REQUIREMENTS. * SEARCH AND RESEARCH PLANT MATERIAL AVAILABLE FOR OPTIONAL REVIEW BY LANDSCAPE ARCHITECT AT SOURCE OF SUPPLY. AREA OF SEARCH TO INCLUDE COLUMBIA AND FRASER VALLEY. * QUANTITIES OBTAIN WRITTEN APPROVAL FROM THE LANDSCAPE ARCHITECT PRIOR TO MAKING ANY SUBSTITUTIONS TO THE SPECIFICATIONS. * UNAPPROVED SUBSTITUTIONS WILL BE REJECTED. ALLOW A MINIMUM OF FIVE DAYS PRIOR TO SUBMITTING REQUEST TO SUBSTITUTE. SUBSTITUTIONS ARE SUBJECT TO BC LANDSCAPE STANDARD AND CANADIAN LANDSCAPE STANDARD, DEFINITION OF CONDITIONS OF AVAILABILITY. * ALL LANDSCAPE MATERIAL AND WORKMANSHIP MUST MEET OR EXCEED BC LANDSCAPE STANDARD AND CANADIAN LANDSCAPE STANDARD, LATEST EDITION. * ALL PLANT MATERIAL MUST BE PROVIDED FROM CERTIFIED DISEASE-FREE NURSERY. * B&B=SHOULDS NOT PERMITTED IN GROWING MEDIUM UNLESS AUTHORIZED BY LANDSCAPE ARCHITECT.

NO.	DATE	REVISION DESCRIPTION	DR.
1	25.03.24	NEW SITE PLAN, REVISION 1	DD
2	25.03.24	REVISED PLAN	BA
3	25.03.24	NEW SITE PLAN	DD
4	25.03.24	NEW SITE PLAN	DD

PROJECT: CLEARCAR OF LANGLEY
5975 COLLECTION DRIVE
LANGLEY, BC

DRAWING TITLE: LANDSCAPE PLAN
DATE: 25.03.24
SCALE: 1/8"=1'-0"
DRAWN: DD
DESIGN: DD
CHKD: MCV



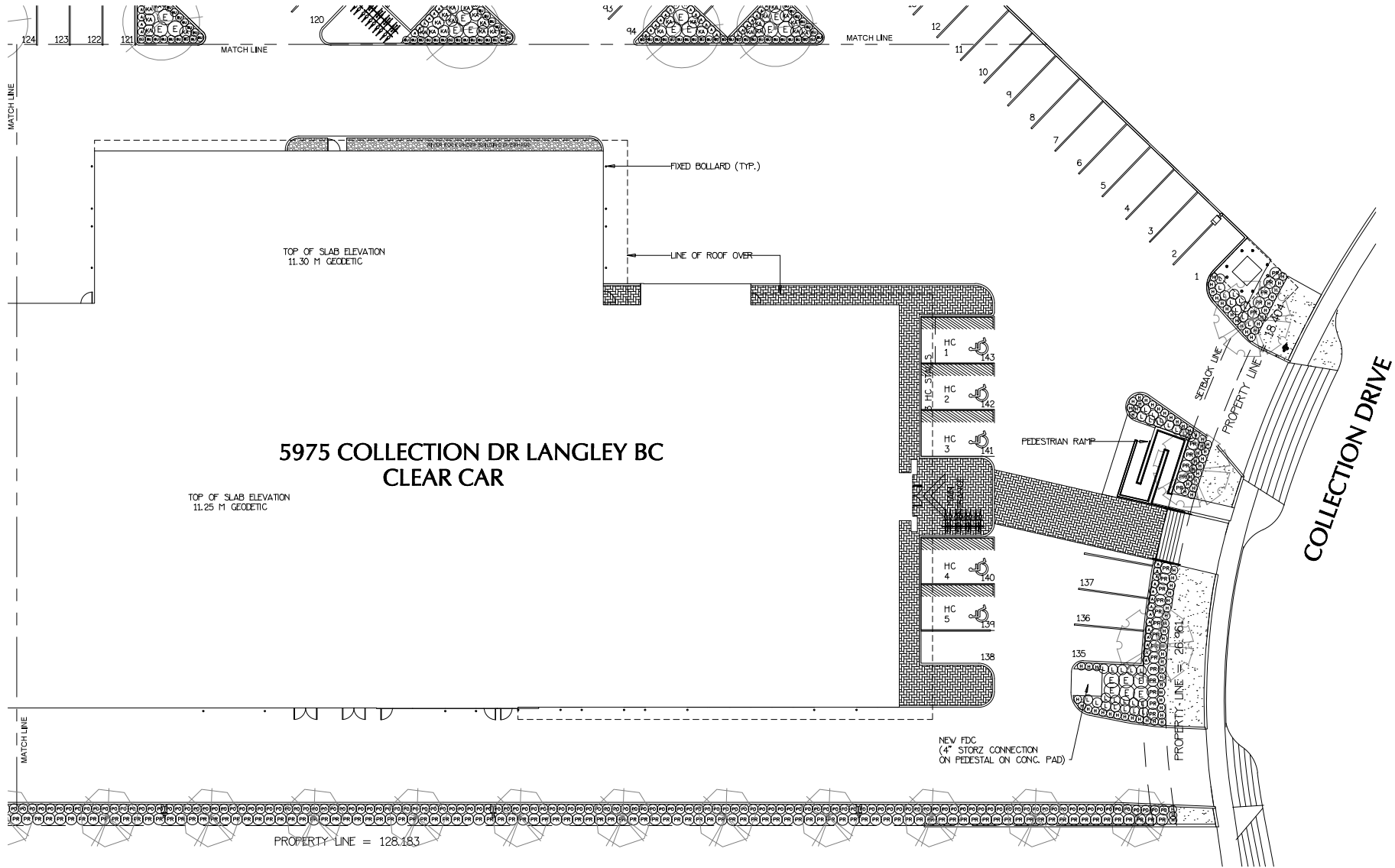

PLANT SCHEDULE				PNG PROJECT NUMBER: 25-008
KEY	QTY	BOTANICAL NAME	COMMON NAME	PLANTED SIZE / REMARKS
○	149	BURUS MICROPHYLLA WINTER GEM	LITTLE-LEAF BOX	#3 POT 45CM
○	104	CORNUS SERICEA	RED COBER DOGWOOD	#2 POT 50CM
○	20	ECYNOSSYALTA COMPACTUS	COMPACT WINGS BURNING BUSH	#3 POT 50CM
○	91	HOLODISCUS DECIDUUS	OCEANSPRAY	#2 POT 50CM
○	95	KALMIA LATIFOLIA 'ELF'	DWARF MOUNTAIN LAUREL	#2 POT 30CM
○	195	MAHONIA AQUIFOLIUM	OREGON GRAPE	#2 POT 45CM
○	401	MAHONIA NIVEOGA	LONGLEAF MAHONIA	#1 POT 20CM
○	184	POTENTILLA FRUTICOSA 'GOLDFINGER'	SHRUBBY CINQUEFOIL GOLD	#2 POT 30CM
○	160	PRUNUS LAURICERASUS 'OTTO LUYKEN'	OTTO LUYKEN LAUREL	#3 POT 50CM
○	108	IBEX SANGUINUM	RED FLOWERING CURRANT	#2 POT 90CM
○	80	HELIOTRICHON SEMPERVIBENS	BLUE OAT GRASS	#1 POT
○	456	ARCTOSTAPHYLOS UVAURIS VANCOUVER JADE	RAINBOWBIRK	#1 POT 20CM
○	27	LONICERA FLEATA	PRIVET HONEYSUCKLE	#2 POT 35CM

NOTES: *PLANT SIZES IN THIS LIST ARE SPECIFIED ACCORDING TO THE BC LANDSCAPE STANDARD AND CANADIAN LANDSCAPE STANDARD, LATEST EDITION. CONTAINER SIZES SPECIFIED AS PER ONLA STANDARD. BOTH PLANT SIZE AND CONTAINER SIZE ARE THE MINIMUM ACCEPTABLE SIZES. **BEHOLD TO SPECIFICATIONS FOR SIZED RED CONTAINER MEASUREMENTS AND OTHER PLANT MATERIAL REQUIREMENTS. *SEARCH AND REPORT WARE MATERIAL AVAILABLE FOR OPTIONAL REVIEW BY LANDSCAPE ARCHITECTS IN PRESENCE OF SUPPLY. AREA OF SEARCH TO INCLUDE LOWER MAINLAND AND FRASER VALLEY. *SUBSTITUTES OBTAINABLE BY APPROVAL FROM THE LANDSCAPE ARCHITECTS PRIOR TO MAKING ANY SUBSTITUTIONS. TO THE SPECIFIED MATERIALS. *SHRUBS MUST BE SET OR SIZED TO MEET THE SPECIFICATIONS. ALLOW A MINIMUM OF 75 DAYS PRIOR TO SUBMITTING REQUEST TO SUBSTITUTES. *ALL PLANT MATERIAL MUST BE SUBJECT TO BC LANDSCAPE STANDARD AND CANADIAN LANDSCAPE STANDARD, DEFINITION OF CONDITIONS OF AVAILABILITY. ALL LANDSCAPE MATERIAL AND WORKMANSHIP MUST MEET OR EXCEED BC LANDSCAPE STANDARD AND CANADIAN LANDSCAPE STANDARD LATEST EDITION. ALL PLANT MATERIAL MUST BE PROVIDED FROM CERTIFIED DISEASE FREE NURSERY. *BEHOLDERS NOT PERMITTED IN GROWING MEDIUM UNLESS AUTHORIZED BY LANDSCAPE ARCHITECTS.

NOTES: MINIMUM DEPTH OF SOIL FOR SODDED AREAS: 300mm
MINIMUM DEPTH OF SOIL FOR SHRUB BED AREAS: 450mm

© Copyright reserved. This drawing and design is the property of PMG Landscape Architects and may not be reproduced or used for other projects without their permission.



Suite C100 - 4185 Still Creek Drive
Burnaby, British Columbia, V5C 6Z9
p. 604.294-0011 f. 604.294-0022



NO.	DATE	REVISION DESCRIPTION	DR.
1	25.03.24	NEW SITE PLAN, REVISED PERMANENCE	DD
2	25.03.24	REVISED PERMANENCE	AA
3	25.03.24	NEW SITE PLAN	DD
4	25.03.24	NEW SITE PLAN	DD

NO.	DATE	REVISION DESCRIPTION	DR.
1	25.03.24	NEW SITE PLAN	DD
2	25.03.24	REVISED PERMANENCE	AA
3	25.03.24	NEW SITE PLAN	DD
4	25.03.24	NEW SITE PLAN	DD

PROJECT:
CLEARCAR OF LANGLEY
5975 COLLECTION DRIVE
LANGLEY, BC

DRAWING TITLE:
LANDSCAPE SHRUB PLAN

DATE: 25.FEB.24 DRAWING NUMBER:
SCALE: 1"=10'-0"
DRAWN: DD
DESIGN: DD
CHKD: MCV OF 4

PNG PROJECT NUMBER: 25-008



25008-5-D1

